



**TOWN OF KINGSTON**  
**Office of the Sewer Commission/Wastewater Department**  
**26 Evergreen Street**  
**Kingston, MA 02364**

781-585-4058  
 FAX 781-585-5874

Elaine A. Fiore  
 Peter C. Cobb  
 Sean M. Walsh

**SEWER SERVICE CONNECTION LOCATION**

Property Owner \_\_\_\_\_

Street and Number \_\_\_\_\_ Map \_\_\_\_\_ Lot \_\_\_\_\_

Contact Phone Number (Day) \_\_\_\_\_ (Evening) \_\_\_\_\_

Please circle one: Single or Multi-family Dwelling.

Please circle one: Residential, Commercial or Industrial

1. Show the proposed route of house service from the building to the street, the locations of any utilities (gas, water, etc.), the existing septic tank, the driveway location, any structures (sheds, garages), and any landscaping features (walls, trees, gardens, etc.).

2. Do you have any wastewater facilities in your basement (e.g. washing machine, toilet, etc.)?  
Please circle one: YES NO

3. Do you plan to install facilities in your basement? Please circle one: YES NO

4. Do you have a sump pump in your basement? Please circle one: YES NO

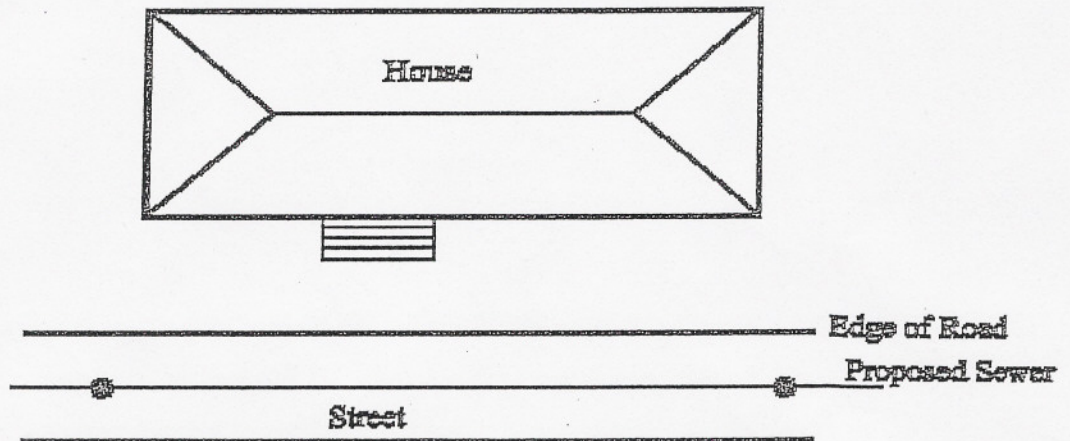

Signature \_\_\_\_\_ Date \_\_\_\_\_

Return to: Wastewater Department  
 26 Evergreen St  
 Kingston MA 02364

August, 2005

## Location of Sewer Service Connection

Where possible, we try to accommodate property owners and to locate service lines at a point best suited to the present plumbing and site conditions (driveways, landscaping, etc.). With respect to this matter, we are requesting that you please indicate on the enclosed form the location of:

- where the existing sewer pipe comes out of the house,
- septic tanks, cesspools, leaching fields,
- existing driveways, sidewalks, large trees,
- water line, gas line,
- shed, and/or garage, if any,
- and the location at which you wish to have your sewer connection enter the house (if different from the existing sewer pipe location).

We suggest that it may be helpful, but not necessary, to seek the assistance of a licensed plumber and/or drain layer to aid you in supplying the information requested. The following example is provided to assist you in completing the card.

### EXAMPLE

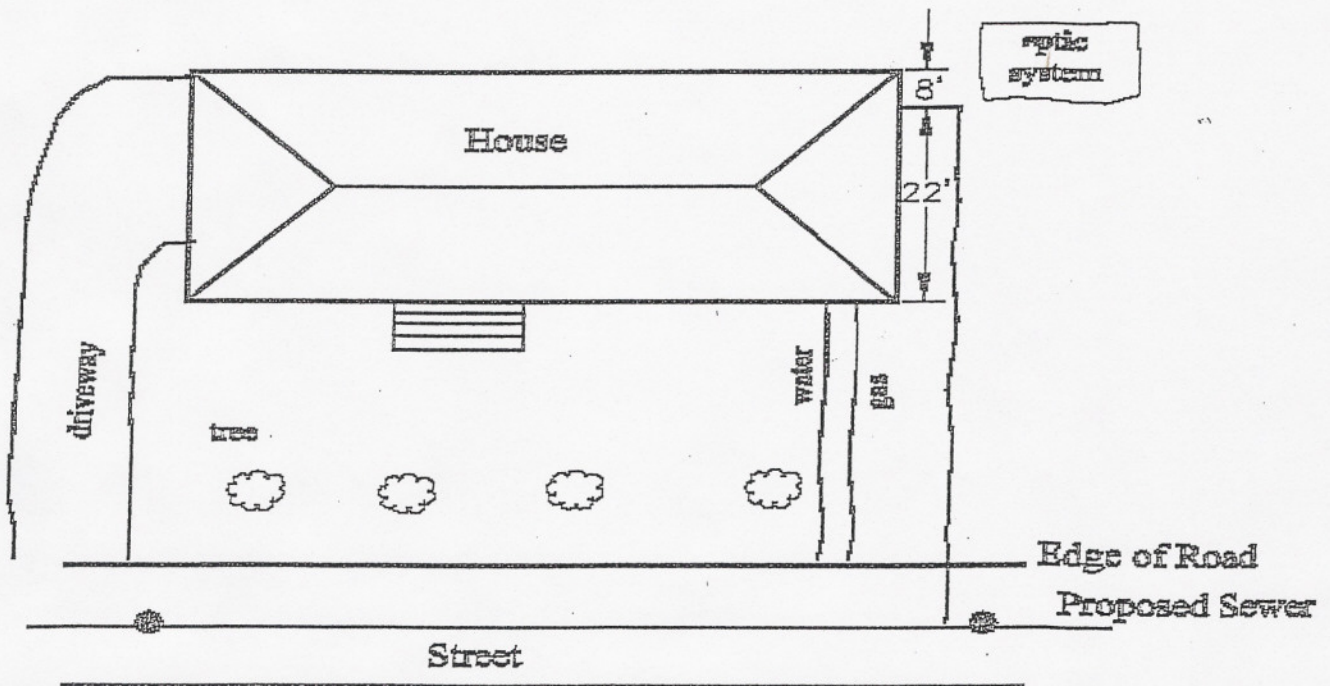

If not returned, the engineer, from Camp, Dresser & McKee will determine the location of the sewer service stub.

No connection from the sewer main in the street to the property line will be changed and/or added after construction is completed.

Storm water, surface water, ground water; roof runoff, submerged drainage and/or sump pumps may not be discharged into the sanitary sewer.

Thank you for your cooperation.